

R28 FILIA

Sisällysluettelo

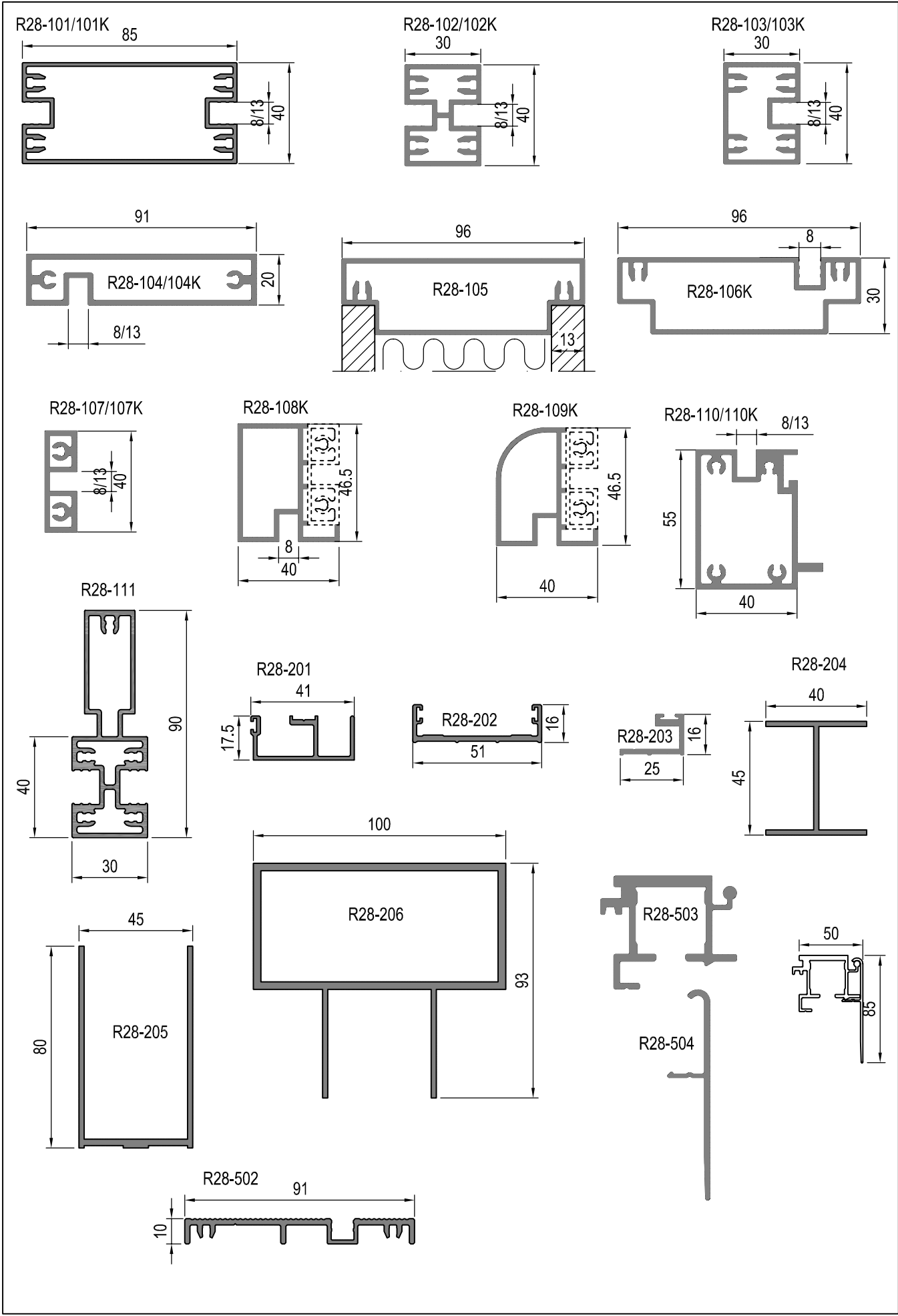



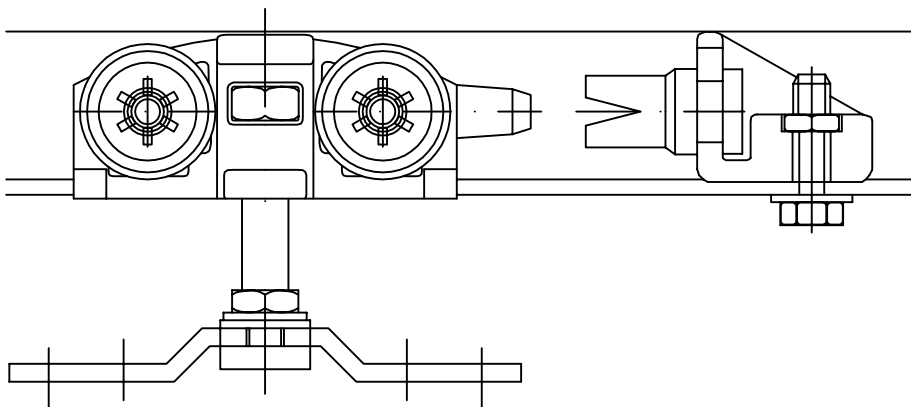

- 1 Profiilit 1:1
- 2 Tarvikkeet
- 3 Liitokset
- 4 Lasitus
- 5 Liukuoven valmistus
- 6 Harjatiivisteellisen liukuoven valmistus



R28-753 (liukuoven rullasto)

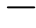

Tiivisteet

R28-676 (6 mm)		613	
R28-678 (8 mm)		614	
R28-6710 (10mm)			
R28-675K (5 mm)			
R28-676K (6 mm)			

Lasiurat

Vakio = 13 mm

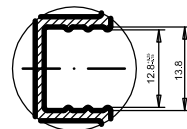

K (kapea) = 8 mm

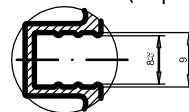

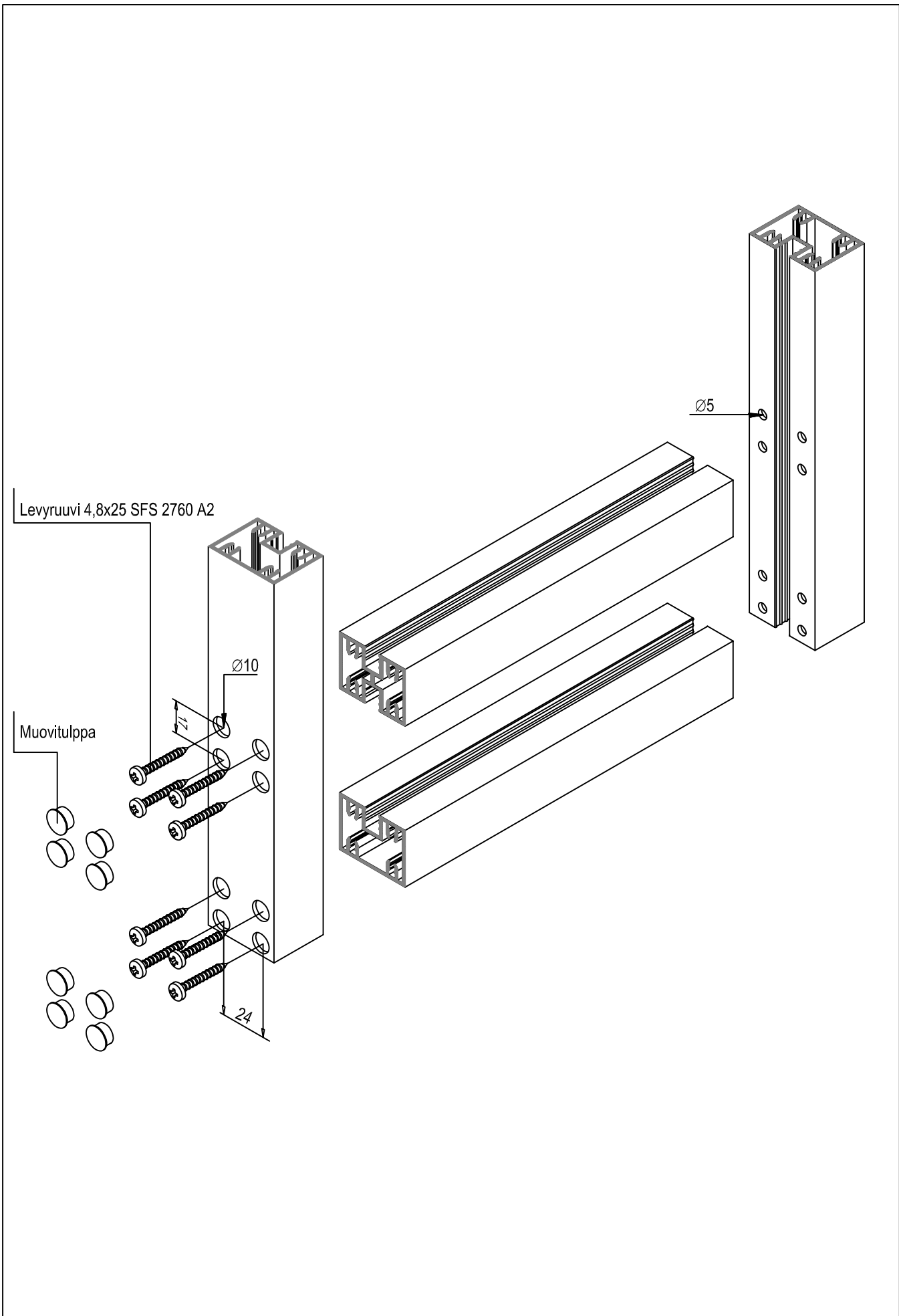

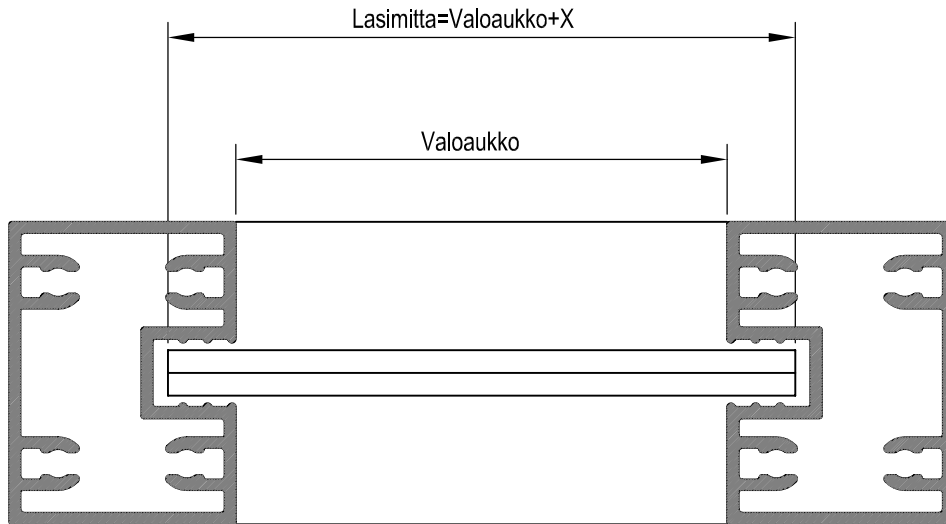

Tiiviste	X	Lasinpaksuus	Materiaali
R28-676	13	6	EPDM
R28-678	15	8	EPDM
R28-6710	17	10	EPDM
R28-675K	16	5	EPDM
R28-676K	17	6	EPDM

Käytettäessä massalasiutusta keskitetään lasi käyttämällä 20 mm pitkiä tiivisteiden pätkiä.

Tukien sijoitus massalasiutuksessa

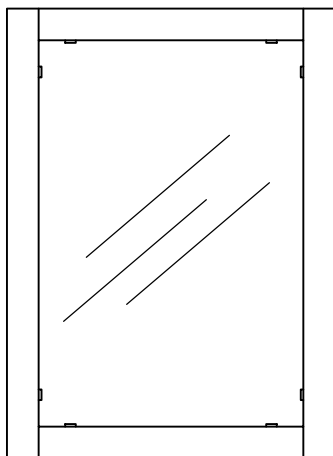

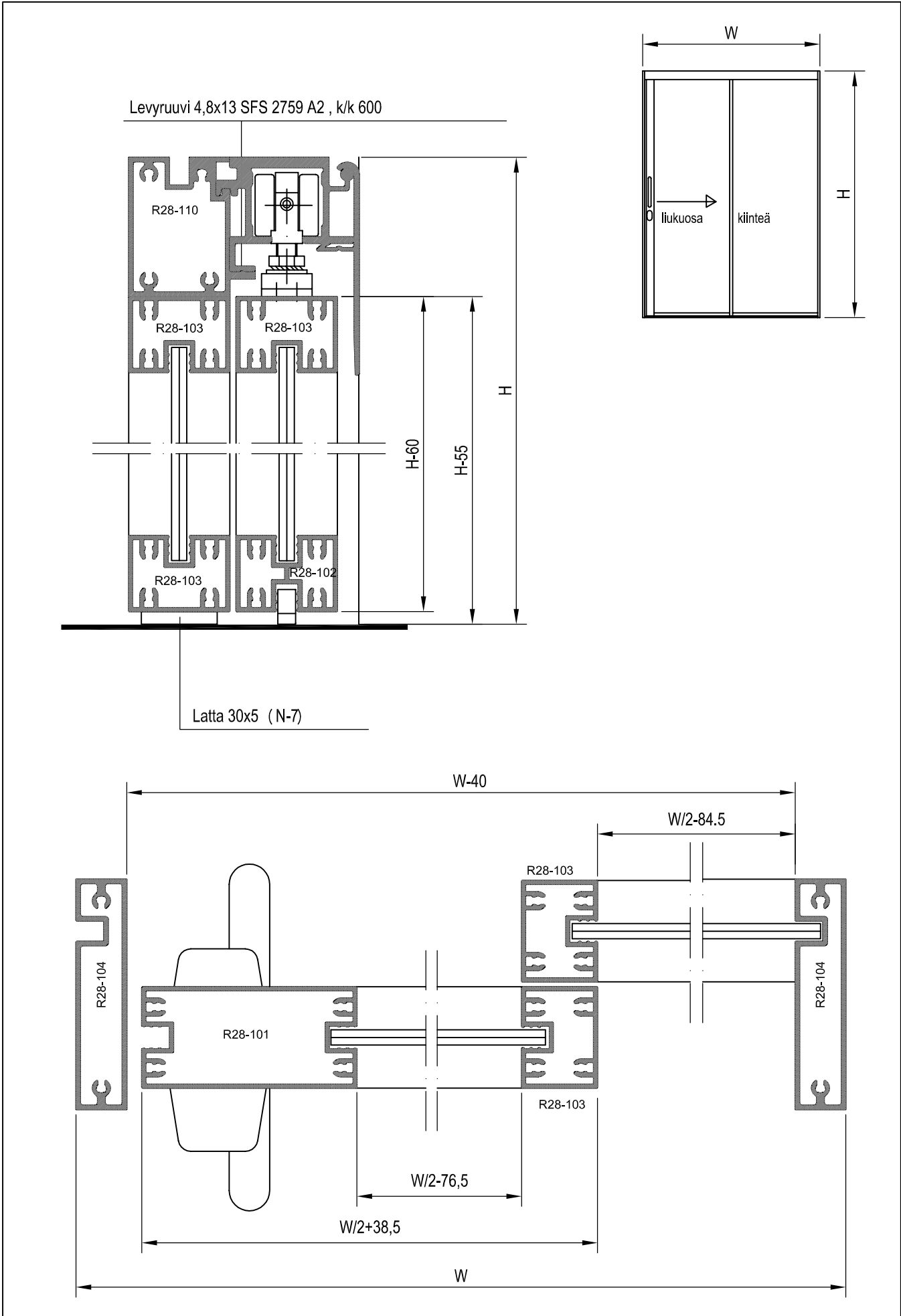

01.07.2013

Levyruuvi 4,8x13 SFS 2759 A2 , k/k 600

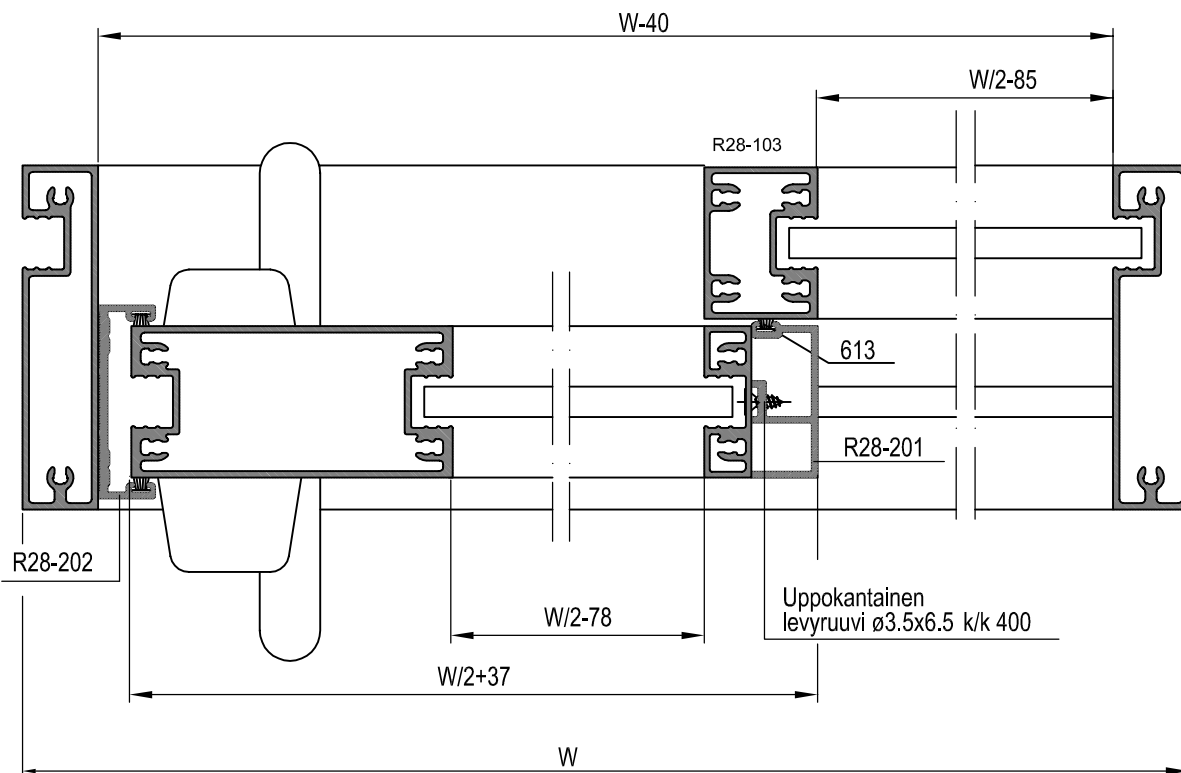
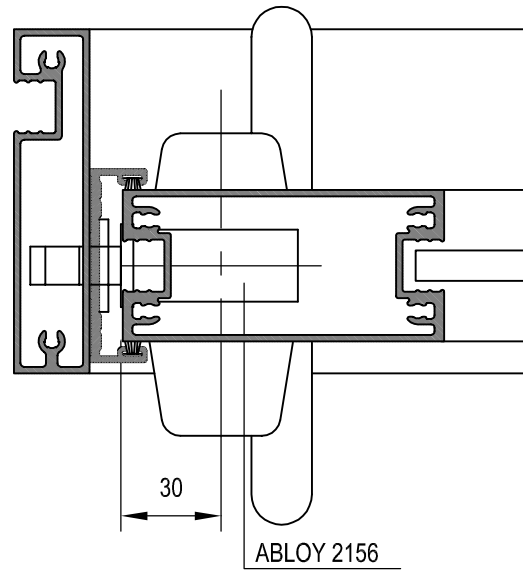
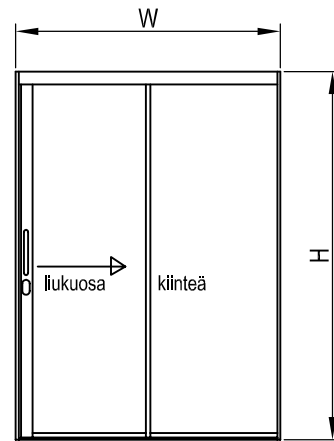
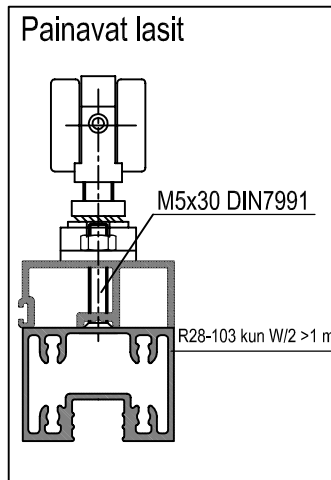
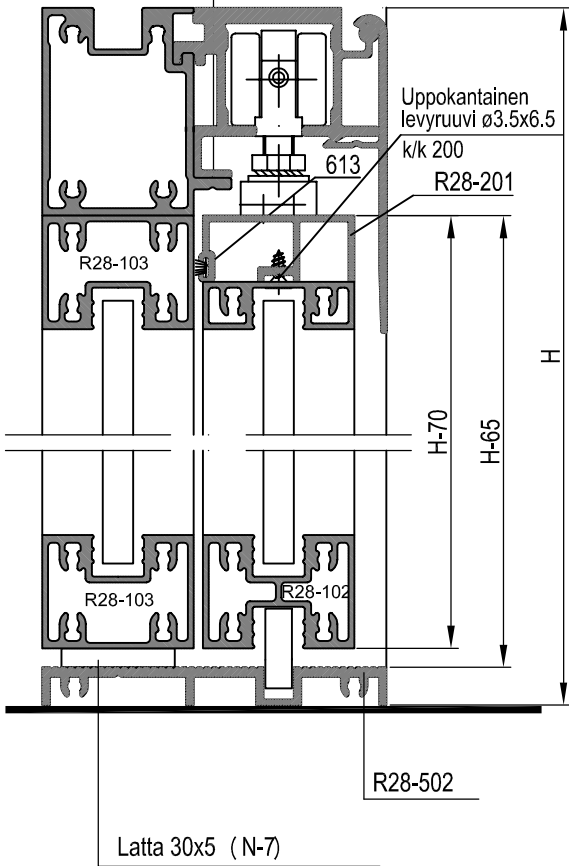

25.02.2016

R28
 FILIA

6

NOKIAN
 PROFILIT

Harjatiivisteellisen liukuoven valmistus